

SI Rod end BEF06-20-502-DURBAL - BEF06-20-502-DURBAL

<https://www.123bearing.co.uk/bearing-housing/rod-end/si/bef06-20-502-durbal>

BEF06-20-502



rod end housing:
forged steel, tempered, surface galvanized, free of Cr-VI

joint ball:
ball bearing steel, hardened and ground, surface superfinished and chromium plated

race:
nylon / teflon / glass fibre compound

tolerances:
see page 10

DURBAL® heavy-duty rod ends with integral spherical plain bearing

female thread:
maintenance free, adapter sizes according to DIN ISO 12240-4, series K, thread according to ISO 8139

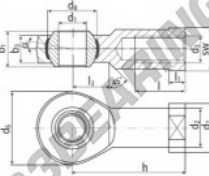

| order number | | measurements [mm] | | | | | | | | | |
|-------------------|-------------------|-------------------|----------------|----------------|----------------|---------------------------------|---------------------------------|----------------|--|----------------|----------------|
| type | right-hand thread | d ₁ | d ₂ | d ₃ | d ₄ | d ₅ | d ₆ | d ₇ | d ₈ | b ₁ | b ₂ |
| BEF 06 | -20 | -502 | 6 | 10,0 | M 6 | | 20 | 13 | 12,65 | 9 | 6,75 |
| measurements [mm] | | | | | | | | | | | |
| type | h | l | l ₁ | l ₂ | SW | α ₁ ¹ [°] | α ₂ ² [°] | weight [kg] | basic load rating dyn. stat. | | |
| BEF 06 | 30 | 12 | 5,0 | 10 | 11 | 13,0 | 6,5 | 0,024 | C C ₀ C ₁₀ [N] [N] [N] | | |

PRODUCT FEATURES

| | |
|------------------|------------------|
| Brand | DURBAL |
| N° Ean13 | 3663952508030 |
| Inside diameter | 6 mm |
| Outside diameter | 20 mm |
| Thickness | 9 mm |
| Type | SI |
| Weight | 24 g |
| Thread | Left-hand thread |
| Lubrication | without |
| Packaging | 1 |

contact@123bearing.co.uk

02038 087 274

CRT4 de Lesquin 60 Rue Du Haut De Sainghin 59273 Fretin FRANCE