

# SA Rod end BEM30-20-501-DURBAL - BEM30-20-501-DURBAL

<https://www.123bearing.co.uk/bearing-housing/rod-end/sa/bem30-20-501-durbal>

## BEM30-20-501



male thread:  
maintenance free,  
adapter sizes  
according to  
DIN ISO 12240-4,  
series K



**DURBAL® heavy-duty rod ends  
with integral spherical  
plain bearing**

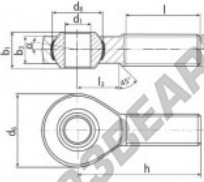

rod end housing:  
forged steel, tempered, rolled thread,  
surface galvanized, free of Cr VI

joint ball:  
ball bearing steel, hardened and ground,  
surface superfinished and chromium  
plated

race:  
nylon / teflon / glass fibre compound

tolerances:  
see page 10

order number		measurements [mm]		weight		basic load rating	
type	type	d <sub>1</sub>	d <sub>2</sub>	d <sub>3</sub>	d <sub>4</sub>	b <sub>1</sub>	b <sub>2</sub>
BEM 30 -20 -501	M 30 x 2	30	M 30 x 2	70	50,75	37	25,0
measurements [mm]		weight		basic load rating		stat.	
type	h	l	l <sub>3</sub>	α <sub>1</sub> °	α <sub>2</sub> °	C	C <sub>G</sub>
BEM 30	110	66	35	17,0	10,5	1,015	55010 145600

## PRODUCT FEATURES

Brand	DURBAL
N° Ean13	3663952507972
Inside diameter	30 mm
Outside diameter	70 mm
Thickness	37 mm
Type	-
Weight	1015 g
Thread	-
Lubrication	-
Packaging	-

[contact@123bearing.co.uk](mailto:contact@123bearing.co.uk)

02038 087 274

CRT4 de Lesquin 60 Rue Du Haut De Sainghin 59273 Fretin FRANCE