

# SA Rod end BEM25-20-501-DURBAL - BEM25-20-501-DURBAL

<https://www.123bearing.co.uk/bearing-housing/rod-end/sa/bem25-20-501-durbal>

## BEM25-20-501



male thread:  
maintenance free,  
adapter sizes  
according to  
DIN ISO 12240-4,  
series K



**DURBAL® heavy-duty rod ends  
with integral spherical  
plain bearing**

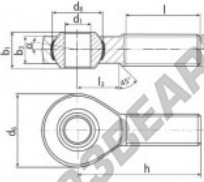

rod end housing:  
forged steel, tempered, rolled thread,  
surface galvanized, free of Cr-VI

joint ball:  
ball bearing steel, hardened and ground,  
surface superfinished and chromium  
plated

race:  
nylon / teflon / glass fibre compound

tolerances:  
see page 10

order number		measurements [mm]		measurements [mm]		weight		basic load rating	
type	right-hand thread left-hand thread	d <sub>1</sub>	d <sub>2</sub>	d <sub>3</sub>	d <sub>4</sub>	l <sub>1</sub>	l <sub>2</sub>	d <sub>ym</sub>	stat. C
BEM 25 -20 -501		25	M 24 x 2	60	42,80	31	22,0		
measurements [mm]		weight		basic load rating					
type	h	l	l <sub>3</sub>	α <sub>1</sub> °	α <sub>2</sub> °	stat. C	stat. C <sub>G</sub>		
BEM 25	94	57	30	15,0	10,0	0,630	45350	118600	

## PRODUCT FEATURES

Brand	DURBAL
N° Ean13	3663952507941
Inside diameter	25 mm
Outside diameter	60 mm
Thickness	31 mm
Type	SA
Weight	630 g
Thread	Right-hand thread
Lubrication	without
Packaging	1

[contact@123bearing.co.uk](mailto:contact@123bearing.co.uk)

02038 087 274

CRT4 de Lesquin 60 Rue Du Haut De Sainghin 59273 Fretin FRANCE