

TAPR Rod end

GIHN-K-80LO-DURBAL - GIHN-K-80LO-DURBAL

<https://www.123bearing.co.uk/bearing-housing/rod-end/tapr/gihn-k-80lo-durbal>

GIHN-K-80LO



Description: Hydraulic rod end with slot and clamping arrangement. Made of spherical plain bearing DGE. LO pressed into rod end housing. Sliding combination steel / steel with grease nipple.

* without grease nipple

female thread;
hydraulic rod ends,
according to
DIN 24338

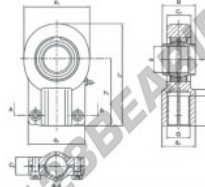

Sliding combination:

steel / steel

Inner ring:
bearing steel, hardened, ground and phosphated

Outer ring:
bearing steel, hardened, ground and phosphated

Lubrication:
lubrication required

| order number | d | d ₁ | measurement [mm] | d ₂ | B | C ₁ | C ₂ |
|--------------|----|----------------|------------------|----------------|-----|----------------|----------------|
| GIHN-K 80 LO | 80 | 168 | M 64 x 3 | 90,0 | 148 | 80 | 66 48 |

| type | l ₁ min | measurement [mm] | l ₂ | l ₁ | load rating C ₀ [kN] | weight [kg] |
|------------------------|--------------------|------------------|----------------|----------------|---------------------------------|-------------|
| GIHN-K / GIHN-KL 80 LO | 86 | 180 | 270,0 | 78 | 695,0 | 14,50 |

PRODUCT FEATURES

| | |
|------------------|-------------------|
| Brand | DURBAL |
| N° Ean13 | 3663952500416 |
| Inside diameter | 80 mm |
| Outside diameter | 168 mm |
| Thickness | 66 mm |
| Type | TAPR |
| Weight | 14500 g |
| Thread | Right-hand thread |
| Lubrication | with |
| Packaging | 1 |
| Standard | No standard |

contact@123bearing.co.uk

02038 087 274

CRT4 de Lesquin 60 Rue Du Haut De Sainghin 59273 Fretin FRANCE