

# TAPR Rod end GIHN-KL-25LO-DURBAL - GIHN-KL-25LO-DURBAL

<https://www.123bearing.co.uk/bearing-housing/rod-end/tapr/gihn-kl-25lo-durbal>

## GIHN-KL-25LO



**Description:** Hydraulic rod end with slot and clamping arrangement. Made of spherical plain bearing DGE. LO pressed into rod end housing. Sliding combination steel / steel with grease nipple.

\* without grease nipple

female thread;  
hydraulic rod ends,  
according to  
DIN 24338

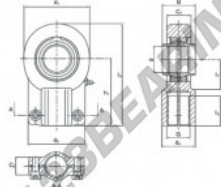

Sliding combination:

steel / steel

Inner ring:  
bearing steel, hardened, ground and  
phosphated

Outer ring:  
bearing steel, hardened, ground and  
phosphated

Lubrication:  
lubrication required

order number	d	d <sub>h</sub>	measurement [mm]	G	d <sub>h</sub>	B	C <sub>1</sub>	C <sub>2</sub>
right hand thread	25	58	M 20 x 1,5	30,0	54	25	22	19
GIHN-KL 25 LO	25	58	M 20 x 1,5	30,0	54	25	22	19

type	l <sub>1</sub> min	measurement [mm]	l <sub>1</sub>	load rating	weight
GIHN-K / GIHN-KL 25 LO	29	h <sub>1</sub>	96,0	78,0 [kN]	0,66 [kg]

## PRODUCT FEATURES

Brand	DURBAL
N° Ean13	3663952500140
Inside diameter	25 mm
Inside diameter	0.984" inch
Outside diameter	58 mm
Outside diameter	2.283" inch
Thickness	22 mm
Thickness	0.866" inch
Type	TAPR
Weight	660 g
Thread	Left-hand thread
Lubrication	with
Packaging	1

[contact@123bearing.co.uk](mailto:contact@123bearing.co.uk)

02038 087 274

CRT4 de Lesquin 60 Rue Du Haut De Sainghin 59273 Fretin FRANCE