

## SI Rod end SIL12-T-K-DURBAL - SIL12-T-K-DURBAL

<https://www.123bearing.co.uk/bearing-housing/rod-end/si/sil12-t-k-durbal>

### SIL12-T-K



female thread:  
maintenance free,  
according to  
DIN ISO 12240-4,  
series K



**Description:** DIN ISO rod end K series. Made of spherical plain bearing DG...PW pressed into rod end body. Sliding combination steel / bronze-PTFE composite.

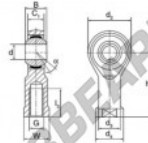

**Rod end body:**  
surface zinc plated

**Sliding combination:**  
steel / bronze-PTFE composite

**Inner ring:**  
bearing steel, hardened, ground and  
spherical surface chromium plated

**Outer ring:**  
brass body pressed around, outer race  
lined with bronze-PTFE composite

**Lubrication:**  
maintenance free

order number		measurement [mm]						
right hand thread	left hand thread	d	G	B	C <sub>1</sub>	d <sub>2</sub>	d <sub>3</sub>	d <sub>4</sub>
	<b>SIL 12 T/K</b>	12	M 12	16	12,00	32	17,5	22

type	measurement [mm]			h	d <sub>1</sub> PT	load rating C <sub>0</sub> [N]	weight [kg]
	l <sub>3</sub> min	W					
SI / SIL 12 T/K	22	19		50	13	24,0	0,100

## PRODUCT FEATURES

Brand	DURBAL
N° Ean13	3663952489261
Inside diameter	12 mm
Inside diameter	0.472" inch
Outside diameter	32 mm
Outside diameter	1.26" inch
Thickness	16 mm
Thickness	0.63" inch
Type	SI
Weight	100 g
Thread	Left-hand thread
Lubrication	without
Packaging	1

[contact@123bearing.co.uk](mailto:contact@123bearing.co.uk)

02038 087 274

CRT4 de Lesquin 60 Rue Du Haut De Sainghin 59273 Fretin FRANCE